

SPI_0070-810-024 Potentiometer, Beta

How to replace the beta potentiometer

APPLICABLE TO: Precision i5, Precision T3

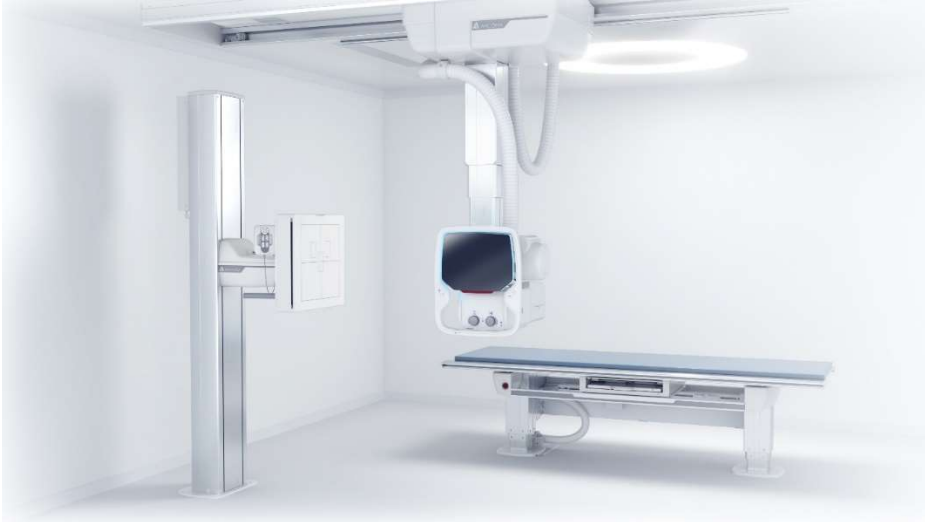

SPARE PART:



Spare part number:

0070-810-024

"Potentiometer, Beta"

TOOLS NEEDED:

- Standard Service tools.
- Tool for circlips.
- Loctite 243 or eqv.
- Heat gun
- Service laptop.
- RS-232 Service cable *p/n 1100-810-201*.



PROTECTIVE MEASURES:

CAUTION!

Printed circuit boards contain electrostatic highly sensitive components requiring particular care in their handling. Ground before making contact and place only on a conductive surface.

CAUTION!

Remaining energy may exist when the equipment is switched off. Always wait at least 15 seconds before working on the system

ACTION STEPS:

1. If possible, position the table in a good working position.
2. Turn the system OFF from the generator mini console.



3. Remove covers and disconnect cables connected to the beta motor unit.
4. Release screws (1) holding the potentiometer and release tension of the belt.
5. **NOTE!** Support the beta motor unit to prevent it from falling.
6. Release and remove screw (3), pulley (4) and belt (5).
7. Remove the beta motor unit (2) by sliding it downwards.

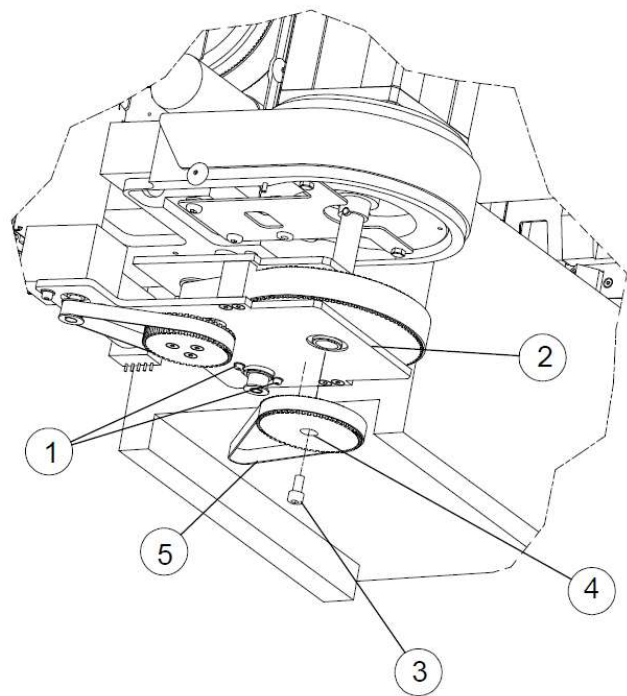

- Place the beta motor unit on a suitable surface for the potentiometer replacement.

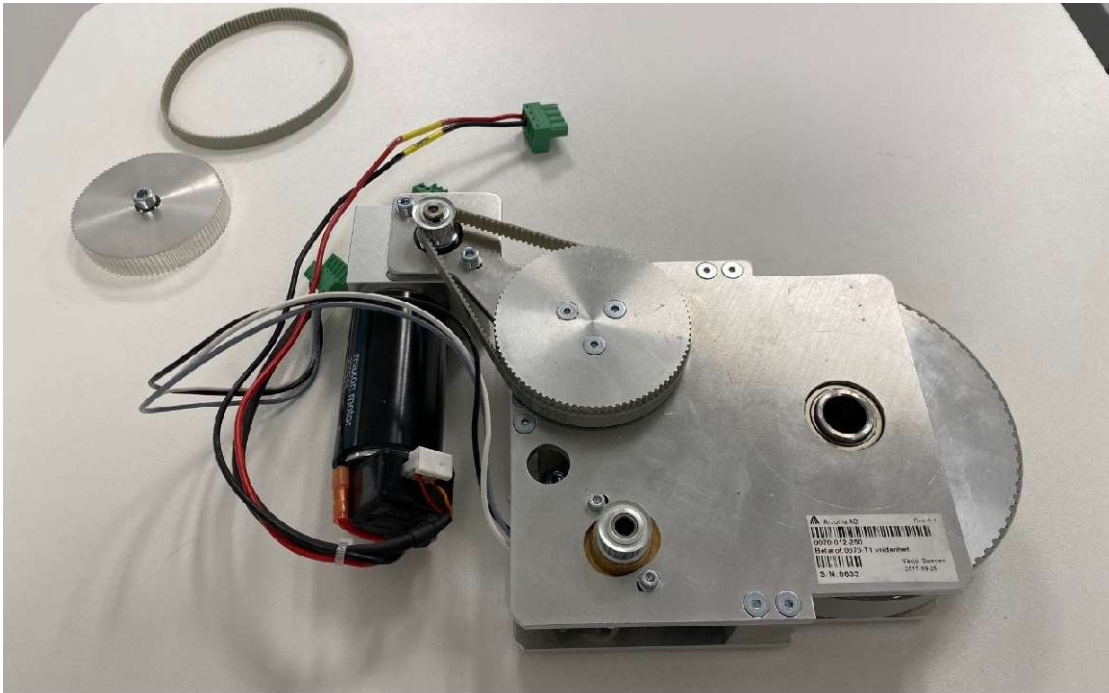

- Use a heat gun to pre-heat the countersunk screws (6 pcs).
The screws are mounted with a thread locking compound. Heating them up will make them easier to remove. **NOTE!** Use good quality tools and be careful not to damage the screw heads.

Use a 2,5 mm hex key to release the six screws in the picture.

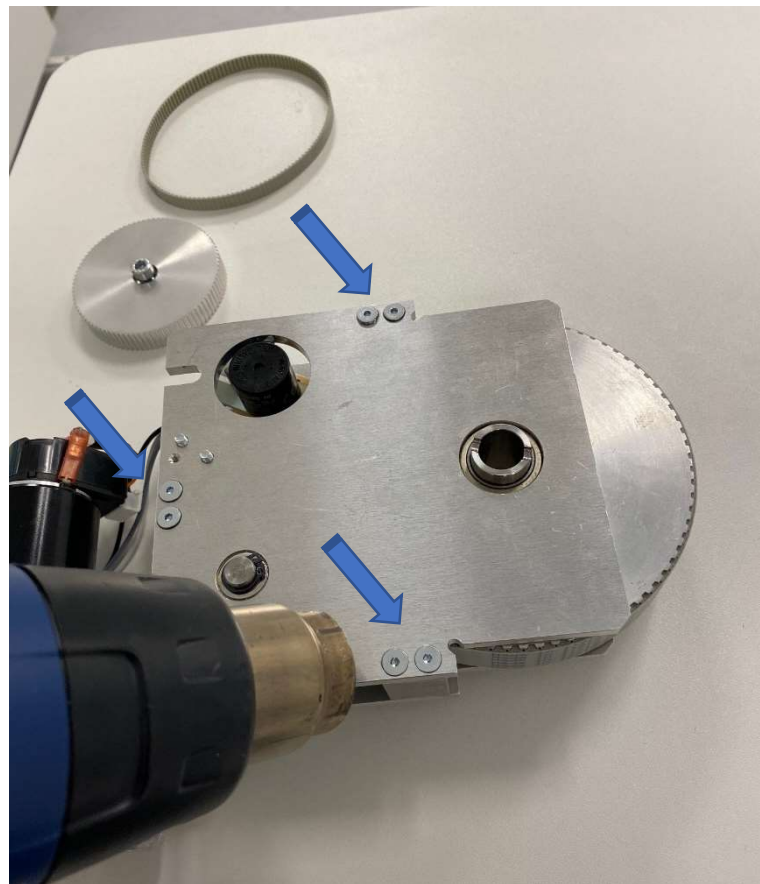

10. Remove the circlip for the motor pulley shaft.

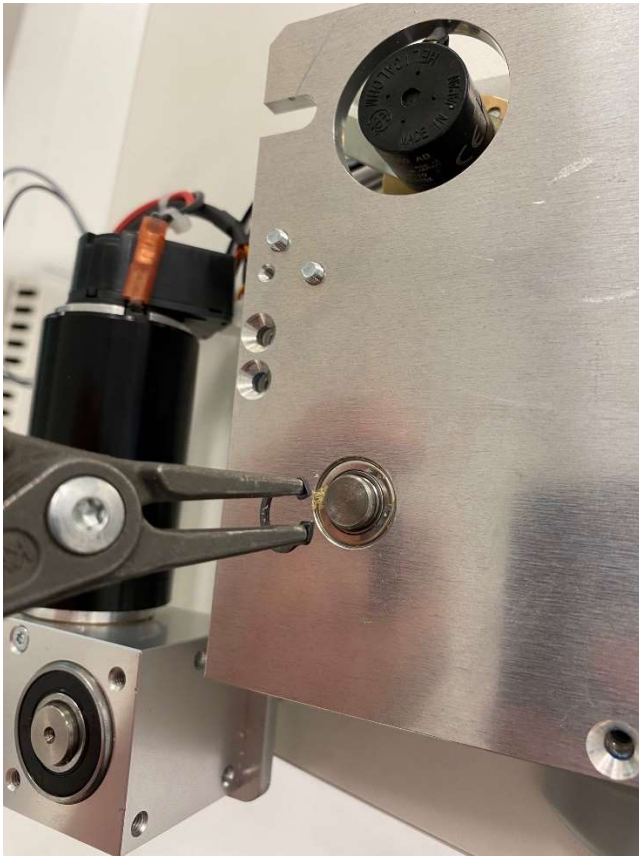

11. Separate the two aluminum plates of the beta motor unit and remove the top one.

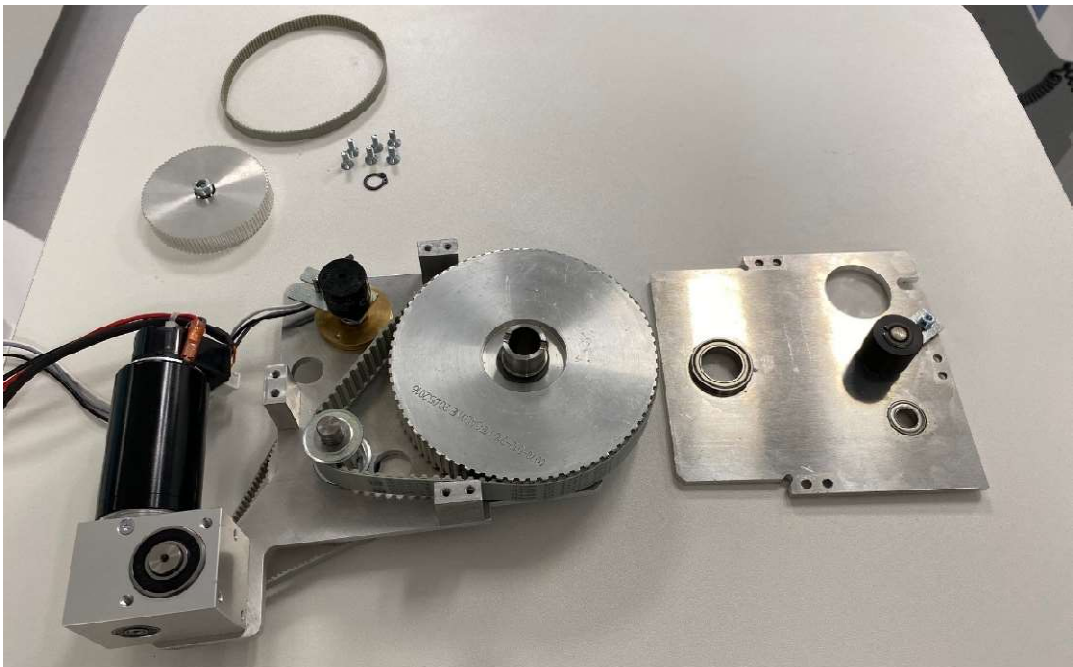

12. Turn the beta motor unit upside down.

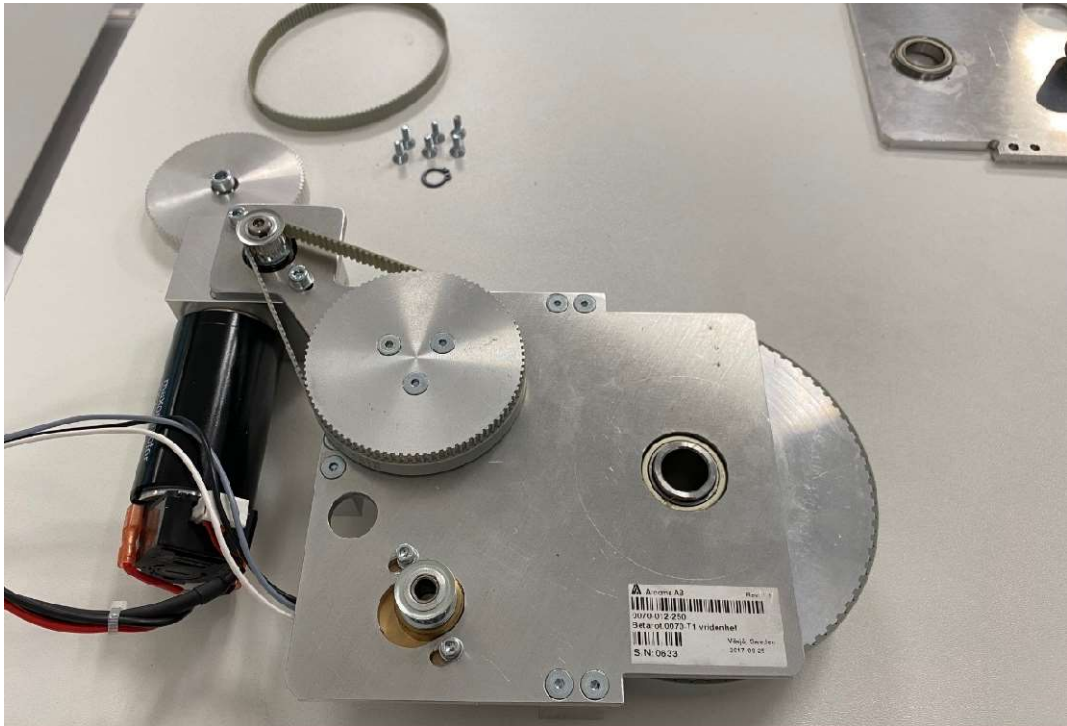

13. Release and remove the two screws for the potentiometer and remove it.

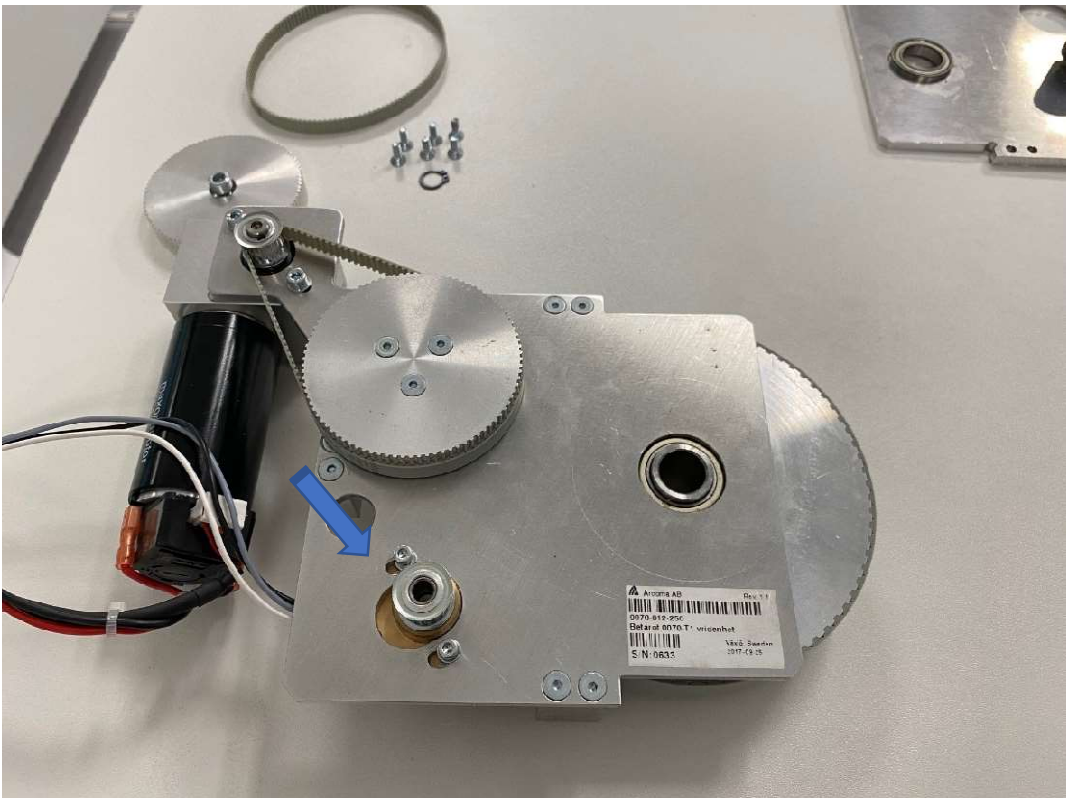

14. Mount the new potentiometer and re-assemble the beta motor unit by reversing the previous steps 6-13. Use Loctite 243 or eqv.



15. Reinstall the beta motor unit on the OTC.
16. Turn the system ON from the generator mini console.



17. Turn the Beta axis to the position of the mechanical end stop in positive direction.
18. Connect the Arco-Ceil service program and enter the Beta node menu. Turn the potentiometer until the Pot. value reaches 3050 (+/-20).

System messages

Access level 3 Connected

19. Position the potentiometer belt between the potentiometer and pulley. Push the potentiometer firmly away from the pulley to create belt tension. Tighten the two screws (1).

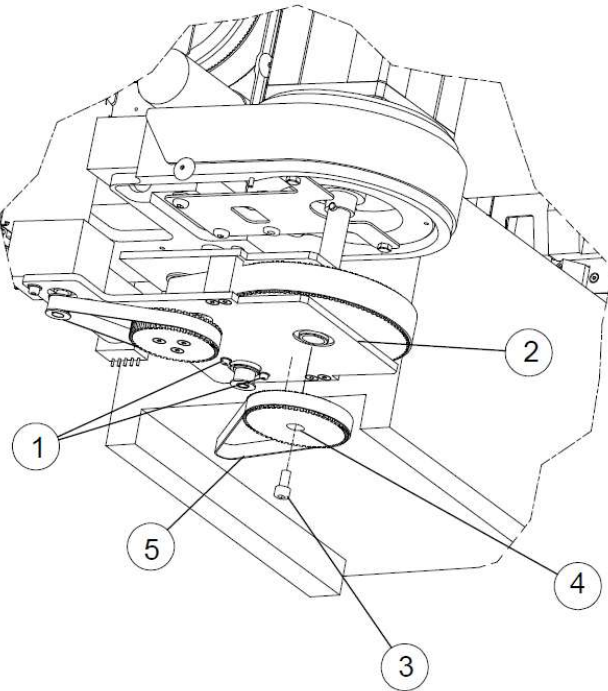

20. Follow the procedure in the Installation & Service manual to Calibrate the Beta axis.

END OF DOCUMENT